

High Reliability 20 mm LED Lamps

SLV-200

GENERAL DESCRIPTION

The SLV-200 series of a large LED lamps encapsulated in epoxy resin with an approximately 19.9 mm diameter and available in red, orange, green and yellow. There is a choice of the two configurations; Two chips are connected in parallel (total 6 chips) as a standard and three chips are connected in parallel as a special unit. Applications are primarily in various industrial equipments and a large instrument pannels requiring a large viewing.

FEATURES

1. Large lens
2. High brightness
3. High reliability and long term stability
4. No saturation in current versus intensity characteristics.
5. Easily identifiable cathode index

INTERNAL CONNECTIONS AND SELECTION GUIDE

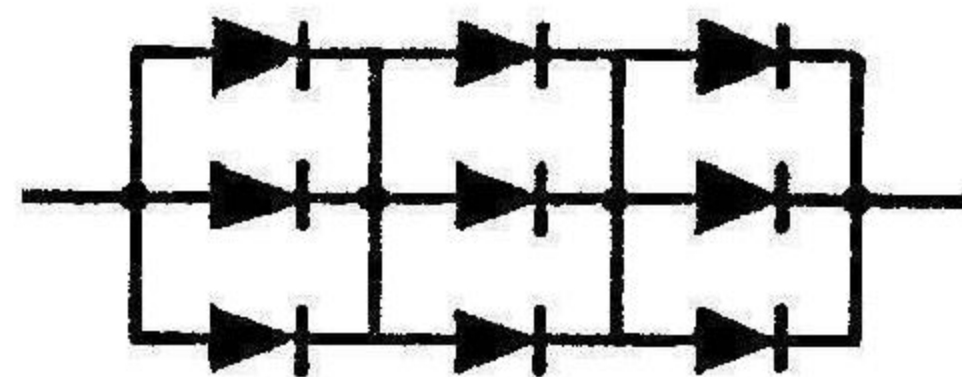

PACKAGE DIMENSIONS

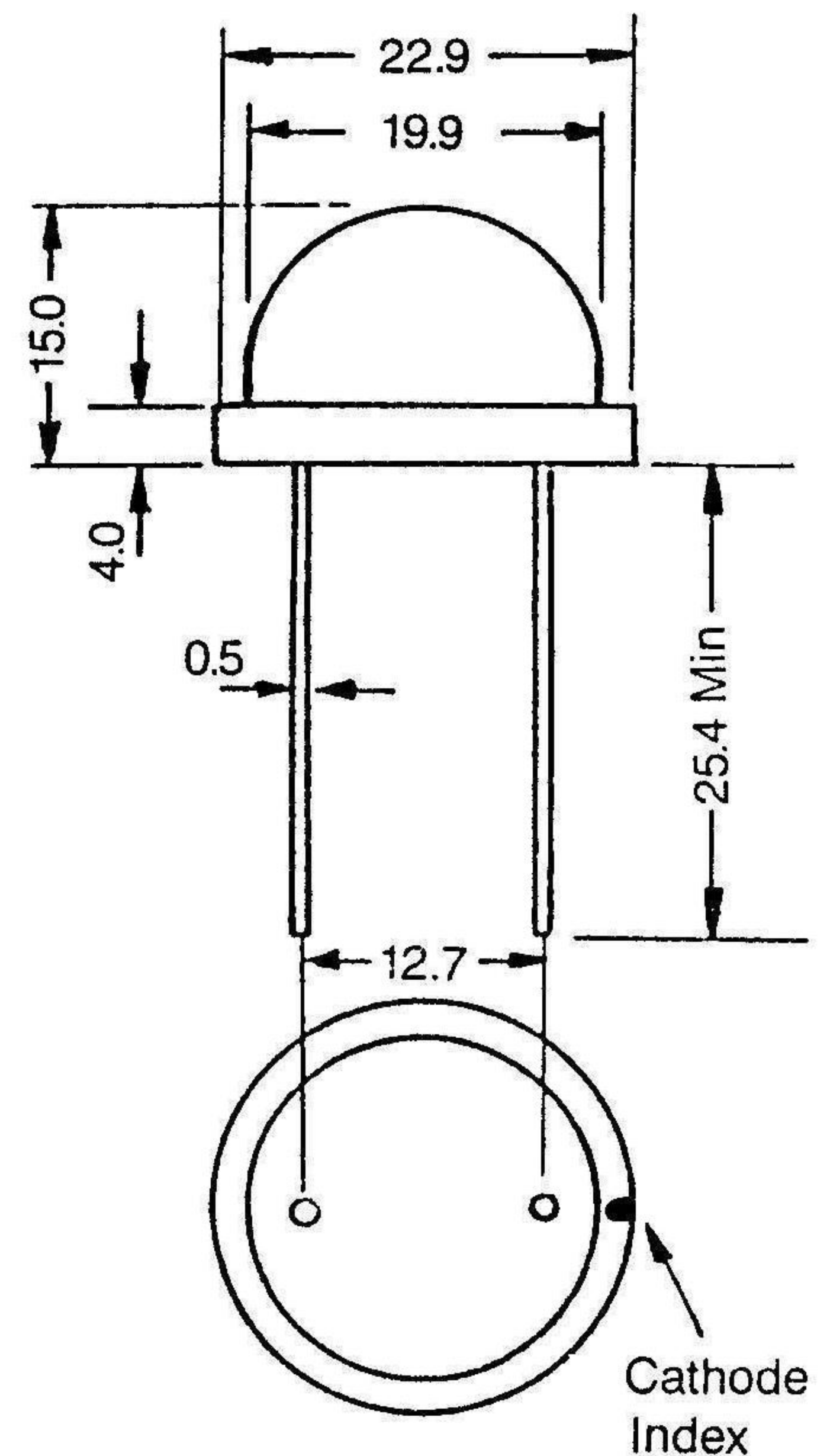

Product No.	Emitting Color (Material)	Forward Voltage (V) @ 60 mA		Luminous Intensity (mcd) @ 60 mA		Ideal Forward Current mA	Power Dissipation mW	Peak Wave Length nm
		Type	Max	Min	Typ			
SLV-200 UR	RED (GaAlAs/GaAs)	5.4	6.0	8.0		45	360	660
SLV-200 UG	Yellow Green (GaP/GaP)	6.6	7.2	11.0		45	432	570
SLV-200 SR	Orange (GaAsP/GaP)	6.3	6.6	13.0		45	396	630
SLV-200 HY	Yellow (GaAsP/GaP)	6.6	7.2	9.0		45	432	585

 三光半導体株式会社
SAM KWANG SEMICONDUCTOR CO., LTD.

803 Silla Techno Vil., 39-3 Dang-dong Kunpo-City Kyungki-do, Korea,
TEL:031-456-1444/1484, FAX:031-456-4224